

Flowmeter Manifold

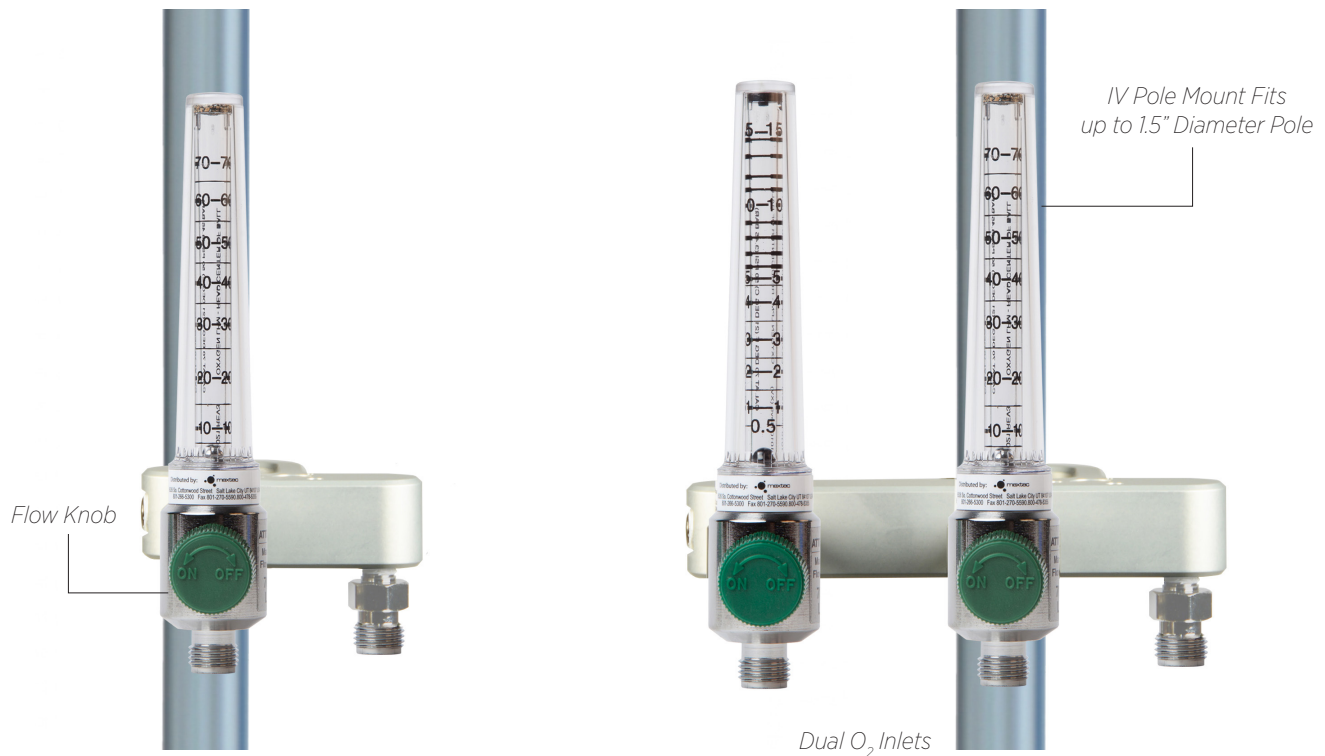

► Flowmeters, where you need them.

The **Flowmeter Manifold** was designed to mount a single or dual flowmeter configuration to an IV Pole of up to a 1.5" diameter. The manifold is equipped with fittings (DISS or NIST) in order to receive gas from a wall or cylinder source. Flow meters can be equipped in multiple combinations

Part Numbers

DISS Options (USA)

0-70 LPM single	R220P01-001
0-70 LPM & 0-15 LPM dual.	R220P11-001
0-15 LPM single (w/hose).	R220P05-002
2-26 LPM single (w/hose)	R220P07-002

See reverse side for additional options

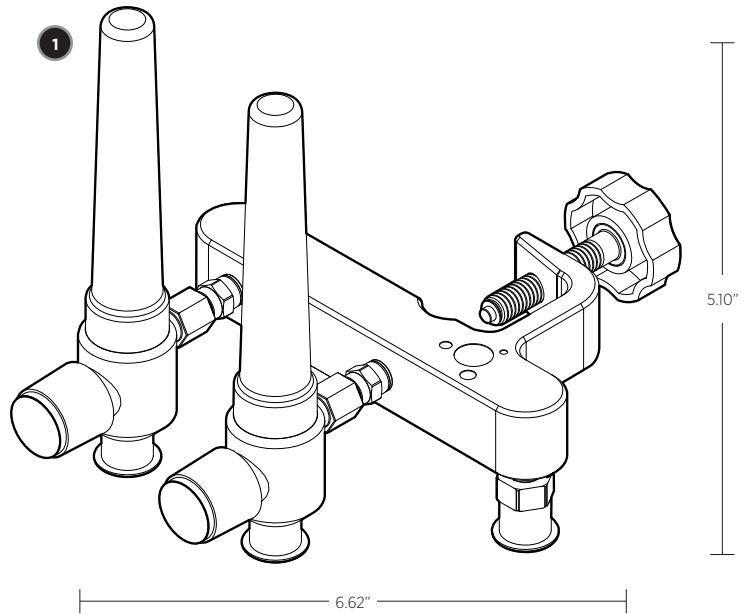
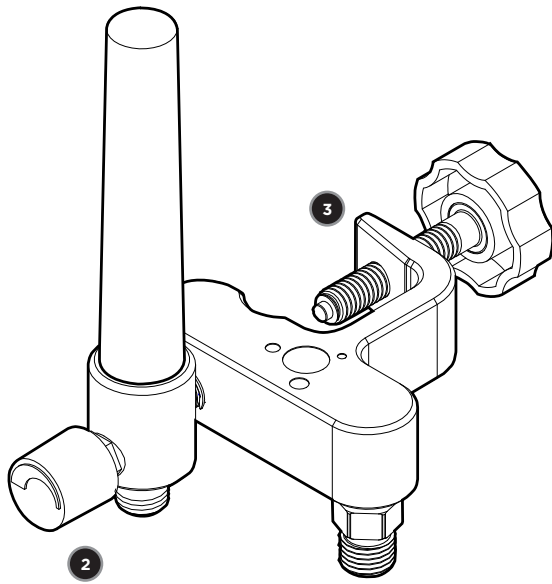

1. Flow Meter(s)

Low flow & high flow available

2. Flow Control Knob

Available in US or ISO colors

3. Pole Mount

For poles up to 1.5" in diameter

Specifications

Max Pressure: 100 psi
 Application: Fits poles up to 1.5" diameter
 Flowmeter: Refer to flowmeter IFU for specifications

International Part Number Options:

NIST (Europe)

0-70 LPM single R220P01-008
 0-70 LPM & 0-15 LPM dual..... R220P11-006
 0-15 LPM single (w/hose)..... R220P05-006
 2-26 LPM single (w/hose) R220P07-006

DISS Nipple Nut (Canada/Australia)

0-70 LPM single R220P01-007
 0-70 LPM & 0-15 LPM dual..... R220P11-005
 0-15 LPM single (w/hose)..... R220P05-005
 2-26 LPM single (w/hose) R220P07-005

NOTE: Additional combinations of flow meters and fittings are available upon request.